

EMERGENCY LIGHT



Lumens Depot Foam's Edge-Lit LED Exit Sign combines modern aesthetics with dependable emergency performance, making it ideal for commercial spaces and code-compliant installations. The sleek edge-lit acrylic panel delivers bright, uniform EXIT illumination in both standard and emergency conditions.

Constructed with flame-retardant, high-impact thermoplastic housing, it is built for durability and long-term use. The fixture supports universal mounting options—including ceiling, wall, and end mounting—and features field-selectable directional arrows for clear guidance.

Equipped with a dual-voltage input and a long-lasting battery providing up to 90 minutes of emergency runtime, this exit sign ensures safety, efficiency, and ease of installation across a wide range of applications.

Product Features

- Output Power: 4W
- Flame retardant, high-impact resistant injection molded thermoplastic
- Minimum 90 minutes emergency operation
- 120/277Vac Dual voltage operation
- 3.6V 500mAh battery

EMERGENCY LIGHT

WATT	INPUT VOLTAGE	OUTPUT VOLTAGE	CRI	BATTERY LIFE	BATTERY BACKUP	CONSTRUCTION	HOUSING	CERTIFICATIONS
1W	120-277V	0.8 Max	>70	3.6V/500mAH NI-MH	90min	ABS	RED	UL

Specifications

Parameter	Description	Value
General Performance	Model	JELCEX1RC
	Mode of operation	Maintained
	Watt	1W
	Input Voltage	120/277V
	Frequency	50/60Hz
	Light Spre ad	120°
	Output Volta ge	5.0V DC MAX
	Output Power	0.8W max
	P.F	0.7
	CRI	≥70
	Battery Life	3.6V/500mAH NI-MH
	Max Charge Current (mA)	50MA
	Max Discharge Current (mA)	260MA MAX
	Charging Time	24H
	Discharge Time	≥1.5H
	LED	SMD 2835 12PCS RED LED
	IP Rating	IP20
	Safety Classification	II
	Certification	UL
Product material	ABS	
Use of environment	0-40oC	

EMERGENCY LIGHT

Dimensions

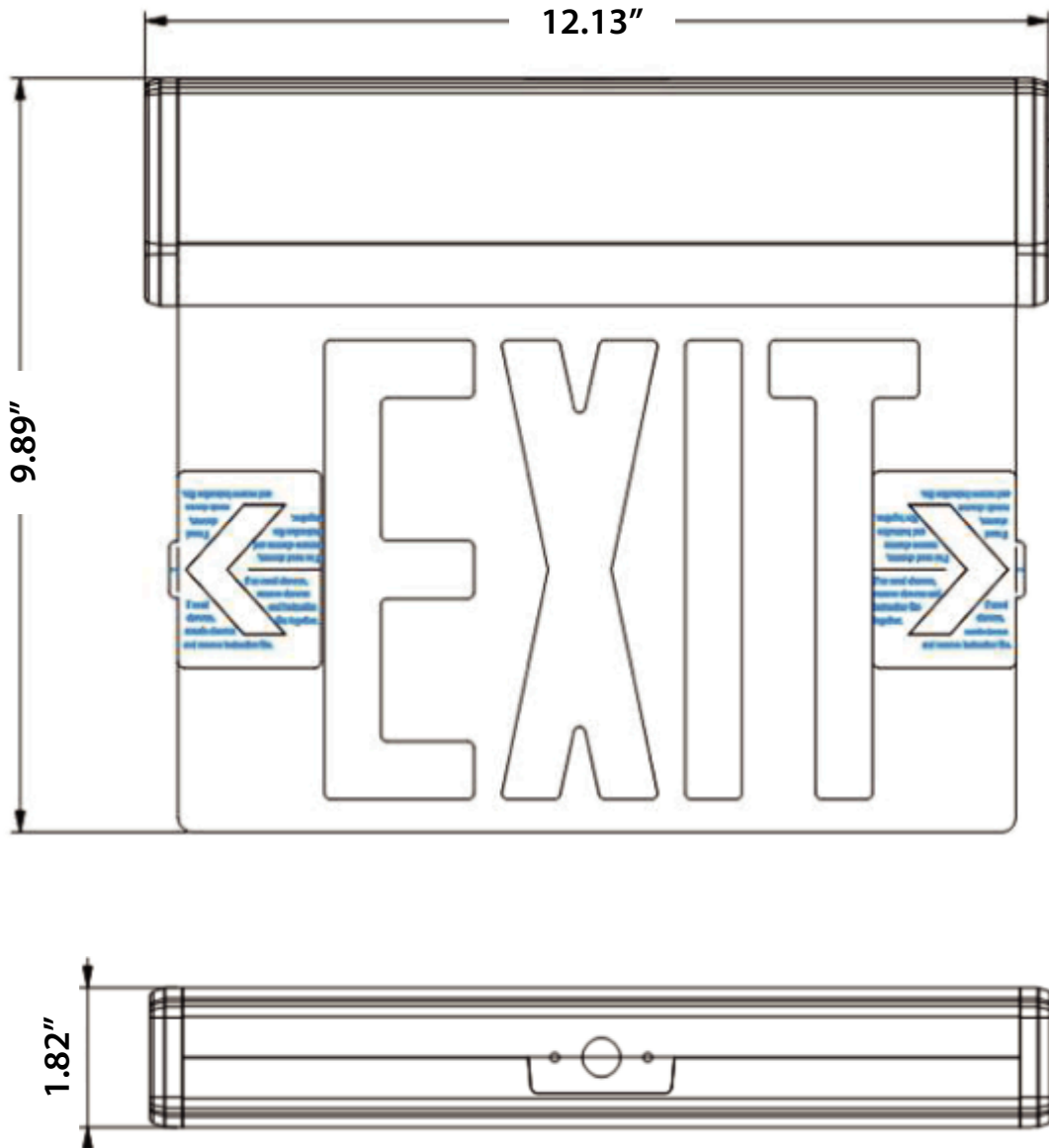

EMERGENCY LIGHT

Installation

01/ PACKAGE CONTENT

LED light panel • 1
Mounting bracket • 1
Wire nut • 3
ST3.516 screw • 2

PM4*20 screw • 2
Crossbar . 1
Screw anchor • 3
ST4*20 screw • 2

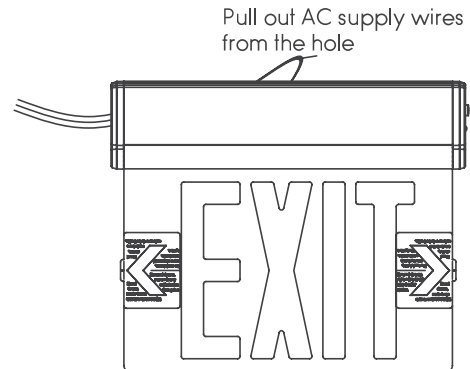

02 / INSTALLATION

CEILING & WALL MOUNT

1. Turn o the power before installing.
2. Attach the crossbar to the junction box (not included).
3. Remove the black rubber ring from the driver box and pull the AC wires out from the hole.

4. Pass the wire through the mounting bracket's central hole. Attach the mounting bracket to the driver box with the ST3.5*16 screws.

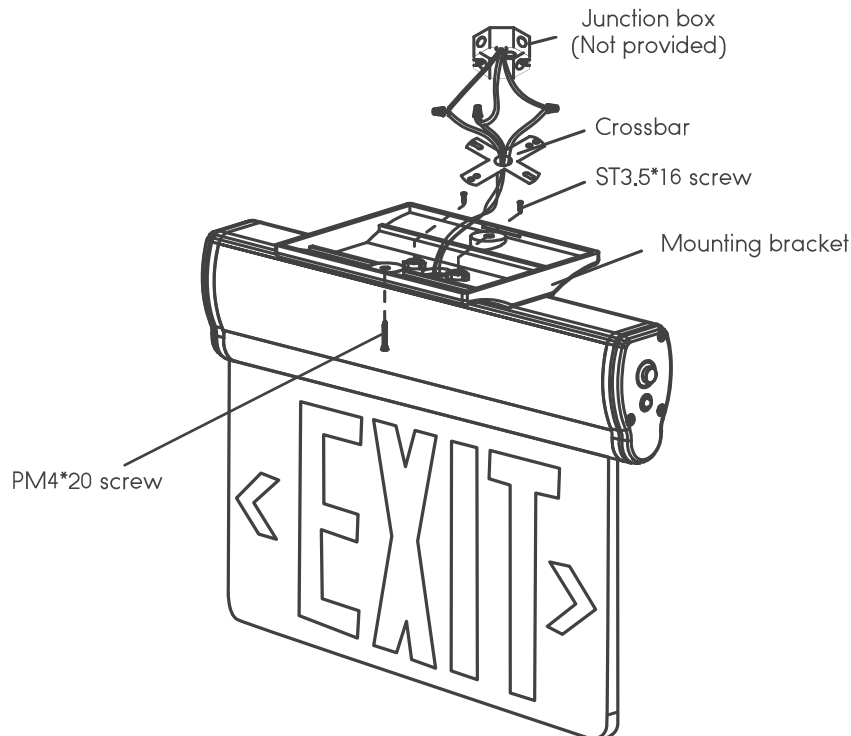

5. Now connect the wires. If you're using 120V AC, connect the black and white wires to the building wires. If you're using 277V AC, connect the red and white wires to the building wires.

EMERGENCY LIGHT

Installation

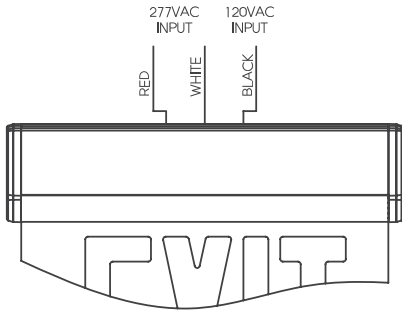

6. Attach the mounting bracket to crossbar with the PM4*20 screws.
7. If the chevrons are needed, PLEASE keep them and tear o the instruction stickers in the panel. If not needed, tear o all the stickers on the panel.
8. The EXIT panel can be rotated up to 180°. Wall mounting can be completed by rotating the mounting bracket 90°.

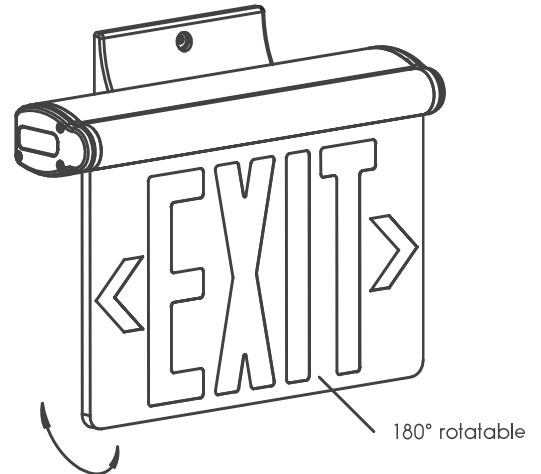

END MOUNT

1. Turn o the power before installing.
2. Attach the crossbar to the junction box (not included).
3. Remove the driver box's side cover and pull out the AC wires. Detach, then reattach the light panel to change its direction if necessary.
4. Pass the wires through the center of both the side cover and mounting bracket. Screw the side cover back to the driver box. Attach the mounting bracket to the tightened side cover with the ST3.5*16 screws.

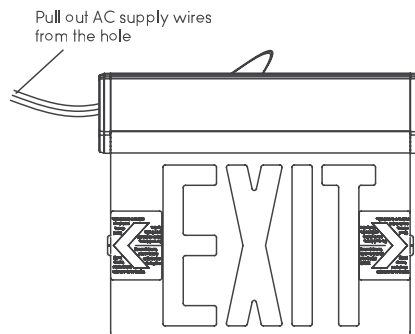

5. Now connect the wires. If you're using 120V AC, connect the black and white wires to the building wires. If you're using 277V AC, connect the red and white wires to the building wires. 6. Attach the mounting bracket to the crossbar with the PM4*20 screws. 7. If the chevrons are needed, PLEASE keep them and tear o the instruction stickers on the panel. If not needed, tear o all the stickers on the panel.

EMERGENCY LIGHT

Installation

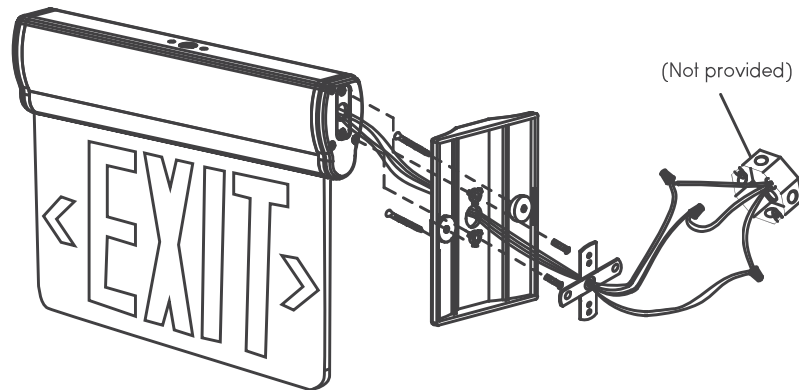

03 / SPECIFICATIONS

Rotating LED Exit Sign Light Panel	
Power	Maximum 4.4W
Voltage	120/277V AC
Beam angle	120°
Certification	UL
Working temperature	32°F-104°F
Material	Acrylic & nanoplastics
Battery type	Ni-MH battery
Battery capacity	3.6V 500mAh

04 / CAUTION •

DO NOT use outdoors.

- This equipment should be mounted in locations and at heights where it will NOT be readily subjected to tampering by unauthorized personnel.
- DO NOT mount near gas or electric heaters.
- Cap off the unused wires with the included wire nuts or with other approved methods.
- Use of equipment that was NOT recommended by the manufacturer may cause an unsafe condition.
- DO NOT use this equipment for ANYTHING other than the intended use.
- ONLY qualified personnel should service this equipment.
- TURN OFF the AC power BEFORE performing ANY service.
- Be careful with the battery if there is lye leaking. Battery lye can cause burns to your skin and/or eyes. If lye is spilled on the skin and/or eyes, flush the lye with fresh water and immediately contact a physician.

05 / WARRANTY

warrants that this product is free from defects in materials and workmanship for 2 years from the day of purchase. If the product has been misused, damaged by accident or in any other way of improper use, this warranty becomes void.

EMERGENCY LIGHT

Application Picture



EMERGENCY LIGHT

Application Picture



EMERGENCY LIGHT

Packaging

Box Dimension	Qty	Net Weight	Gross Weight
19.29" x 13.78" x 9.84"	6 Pcs/Box	18.8LBS	19.8LBS