

# LED T8 GASS TUBE



Lumens Depot Foam's LED Strip Fixtures deliver high-efficiency performance, making them an excellent replacement for low-voltage, halogen, or fluorescent luminaires. Designed with integrated drivers and a self-supporting structure, these fixtures allow for easy surface-mounted installation.

With adjustable wattage and selectable CCT options, they provide flexible lighting solutions to suit a variety of indoor applications. Multiple units can be seamlessly linked together—up to 20 pieces for 4-foot fixtures or 10 pieces for 8-foot fixtures—making them ideal for continuous, uniform lighting in commercial and residential spaces.

## Product Features

- Up to 130 lm/W
- Adjustable wattage
- Adjustable CCT
- Linkable design
- Direct line voltage
- 0-10V Dimmable
- 120° Beam Angle
- Input Voltage 120-277VAC
- UL & DLC listed
- 5-year warranty

# LED T8 GASS TUBE

ADJ. WATT	MAX LUMENS	ADJ. CCT	INPUT VOLTAGE	CRI	SIZE	LIGHT SPREAD	EMERGENCY BATTERY BACKUP	CONSTRUCTION	CERTIFICATIONS
20W/30W/40W	5200	3500K/4K/5K	120-277V	>80	4'	120°	N/A	Metal+PC	UL & DLC

## BROOKS WITH BUILT-IN BATTERY BACKUP

156742	20W/30W/40W	5200	3500K/4K/5K	120-277V	>80	4'	120°	8W Built-In	Metal+PC	UL & DLC
156741	40W/60W/80W	10400	3500K/4K/5K	120-277V	>80	8'	120°	8W Built-In	Metal+PC	UL & DLC

## Specifications

Parameter	Description	Value
General Performance	Adjustable Watt	20W / 30W / 40W
	Color Temperature	3500K / 4000K / 5000K
	Max Lumens	5200
	Lumen Efficacy	Up to 130LM/W
	CRI (Ra)	>80
	Light Spre ad	120o
Electrical	Input Voltage	120-277V
	Frequency	50/60Hz
	Dimming	0-10V Dimmable
	PF	>0.9
	THD	<20
	Flicker Percent	Non-Flicker
	Driver Brand	Beyond
	Driver Model	SDU40CS090V42DN3A
Physical	Operating Temperature	-20oC-40oC
	Storage Temperature	-25oC-80oC
	Storage Humidity	5%RH Min; 95H Max
	LED Brand	Lumileds
	LED Type	2835
	LEDs QTY	280 Pcs
Qualification	Construction	Metal
	Housing Color	White
	IP Rating	IP20
	Warranty	5 Years

# LED T8 GASS TUBE

## Specifications

Parameter	Description	Value
General Performance	Adjustable Watt	40W / 60W / 80W
	Color Temperature	3500K / 4000K / 5000K
	Max Lumens	10400
	Lumen Efficacy	Up to 130LM/W
	CRI (Ra)	>80
	Light Spread	120o
Electrical	Input Voltage	120-277V
	Frequency	50/60Hz
	Dimming	0-10V Dimmable
	PF	>0.9
	THD	<20
	Flicker Percent	Non-Flicker
	Driver Brand	Beyond
Driver Model	SDU80CS180V42DL3A	
Physical	Operating Temperature	-20oC-40oC
	Storage Temperature	-25oC-80oC
	Storage Humidity	5%RH Min; 95H Max
	LED Brand	Lumileds
	LED Type	2835
	LEDs QTY	560 Pcs
Construction	Metal	
Qualification	Housing Color	White
	IP Rating	IP20
	Warranty	5 Years

# LED T8 GASS TUBE

## Correlated Color Temperature (CCT)

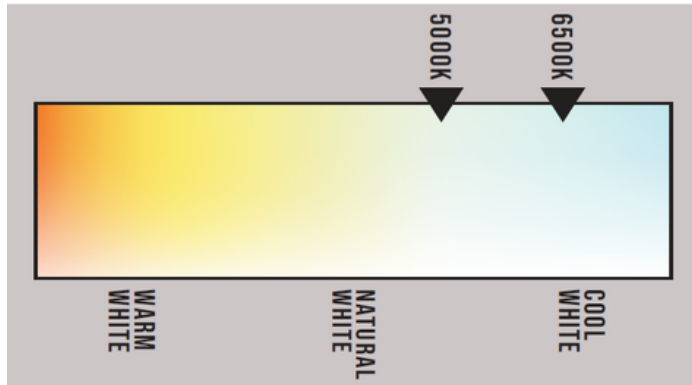

## Dimensions

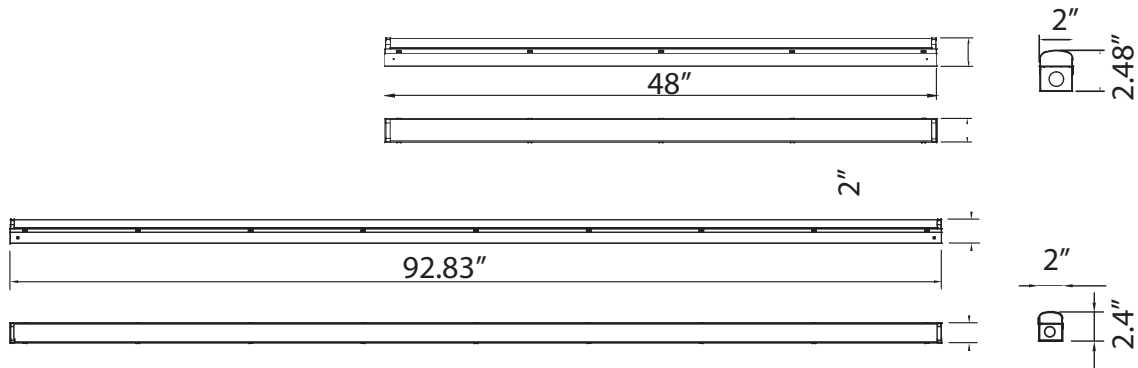

## Accessories

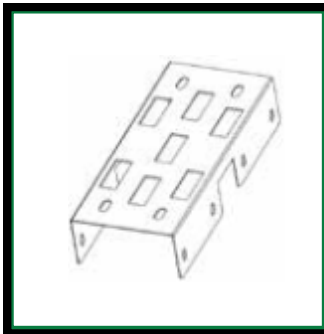

Joiner Bracket (Optional)

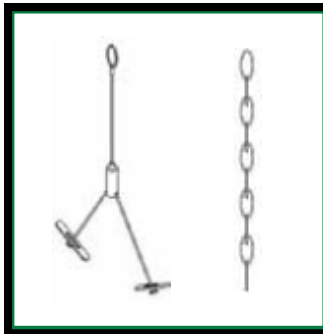

Aircraft cable & Chain (Optional)



Motion Sensor (Optional)



LED Emergency Driver

# LED T8 GASS TUBE

## Photometric Data

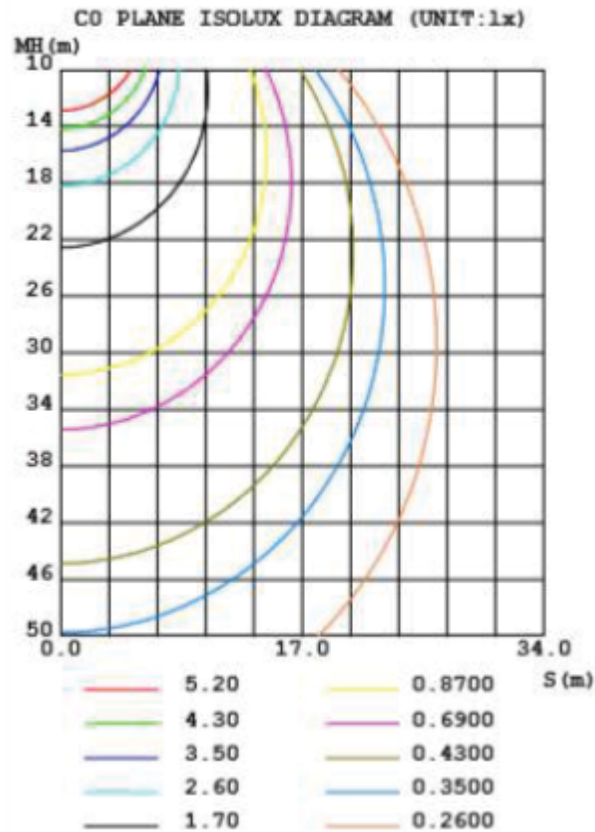
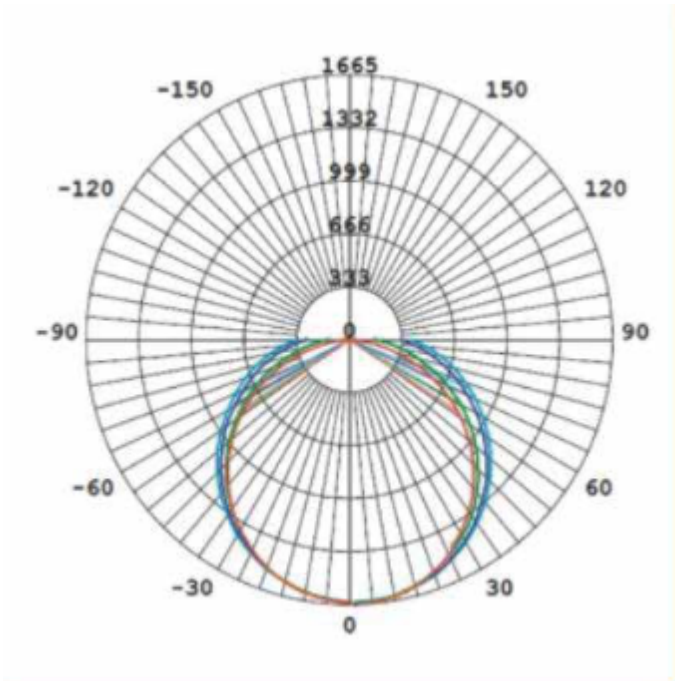

# LED T8 GASS TUBE

## Installation

### IMPORTANT

**READ INSTRUCTIONS CAREFULLY BEFORE INSTALLING.  
KEEP THESE INSTRUCTIONS FOR FUTURE REFERENCE.  
IMPORTANT SAFETY INFORMATION:**

- Turn off electrical power at fuse or circuit breaker box before wiring fixture to the power supply.
- Turn off the power when you perform any maintenance.
- Verify that supply voltage is correct by comparing it with the luminaire label information.
- Make all electrical and grounded connections in accordance with the National Electrical Code and any applicable local code requirements.
- All wiring connections should be capped with UL approved wire connectors.
- MIN 90 °C SUPPLY CONDUCTORS .

**CAUTION:** This luminaire must be wired in accordance with the National Electric Code and applicable local codes and ordinances. Proper grounding is required for safety.

**CAUTION:** Installation and servicing of this luminaire should be performed by qualified personnel only.

**CAUTION:** This fixture is designed for permanent installation in ordinary (Non-Hazardous) locations in accordance with the National Electrical Code and all applicable local codes. Do not use in areas of limited ventilation or in high ambient enclosures. The lamp and fixture operate at high temperatures. Contact with combustible materials can cause fire and personal contact can cause severe burns.

### General Notes

Many luminaire components, such as reflectors, refractors, lenses, sockets, lamp holders, and LEDs are made from various types of plastics which can be adversely affected by airborne contaminants. If sulfur based chemicals, petroleum based products, cleaning solutions, or other contaminants are expected in the intended area of use, consult factory for compatibility.

### Cleaning and Maintenance:

Caution: Do not clean or maintain while the luminaire is energized. Check that the luminaire temperature is cool enough to touch. Periodically check and remove any accumulated dirt or debris around luminaire. Do not touch LEDs.

### General Wiring Diagram

Caution: All units must be individually connected to the AC Supply.

Select appropriate access point for your installation, remove knockout and feed power leads through hole. Connect the supply wire from the source to the driver.

Black= Line White= Neutral Green= Ground

\*\*Consult with dimmer control manufacturer's wiring instructions.

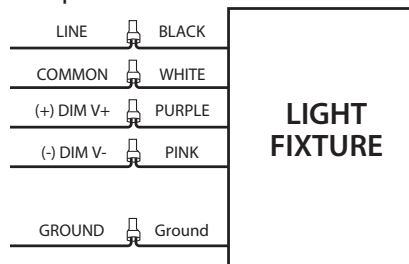

# LED T8 GASS TUBE

## Installation

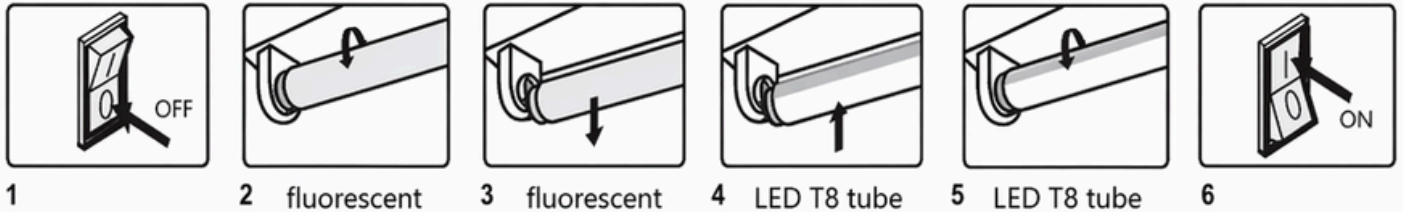

1. Switch off the power before replacement.
2. Remove diffuser(if needed).
3. Remove the existing fluorescent lamp.
4. Verify the existing ballast is on our ballast list or not.
  - If led tube can be compatible with existing ballast:
  - Plug T8LED tube into lamp holders of existing fixture
  - Put on diffuser(if removed in step 2)
  - Turn on power and check the light distribution.

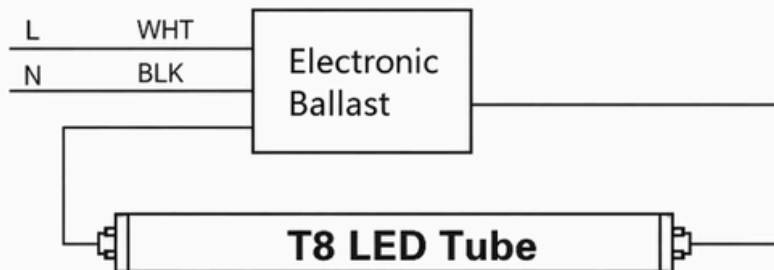

- If LED tube can't be work with existing ballast or the ballast is dead:
- A qualified electrician needed
- Remove the existing ballast and rewire as AC 100-277V input
- Put onLED tube into the lamp holders of existing fixture
- Put on the cover diffuser (if needed)
- Turn on the power and check the light distribution.

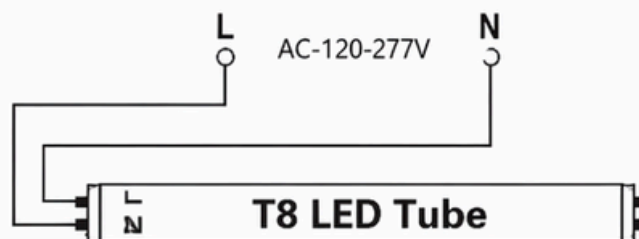

# LED T8 GASS TUBE

## Packaging

Box Dimension	Size	Qty	Emergency Battery Backup	Net Weight	Gross Weight
49.6" x 7.5" x 9"	4FT	9 Pcs/Box	-	29.04LBS	33.52LBS
49.6" x 7.5" x 9"	4FT	9 Pcs/Box	With Battery Backup	24.64LBS	35.72LBS
94.17" x 5.04" x 5"	8FT	4 Pcs/Box	With Battery Backup	30.86LBS	36.38LBS

## Application Image



# LED T8 GASS TUBE

## Application Image

